

FLOS

■ F0095030 Black

Aim Small

Designed by Ronan & Erwan Bouroullec, 2014

12W - 725lm - 2700K - CRI> 90

Suspended light fitting. Body in varnished aluminium sheet, shade in photo-etched optical polycarbonate. Internal reflector in photo-etched PC. Directionable body. Powered directly from mains. The LED can be dimmed with a «Triac for Led» dimmer approved by Flos. Flos does not respond in case of wrong electrical connection system installations. The cable has a useful length of 9 metres and thus the lamp can be suspended 3 metres from the ceiling. Multiple rose with capacity to connect up to 5 Aim Small also available.

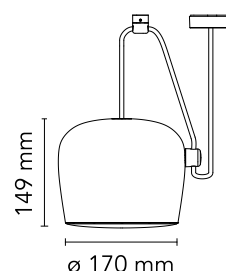

Are you a professional and your project needs consulting and support?

BOOK AN APPOINTMENT

Main specifications

EAN	8059607013526
Mounting	Suspension
Environments	Indoor dry location
Light Source Type	LED
LED type	LED Module
Power (W)	12
System flux (lm)	725

Physical

Colour	Black
Length (mm)	170
Cord length (mm)	9000
Net weight (kg)	1.35
Package height (mm)	310
Package width (mm)	300
Package length (mm)	300
Package volume (m3)	0.03
IP internal	20

Download

Mounting instructions	↓ PDF
Compatible dimmers	↓ PDF
Spare Parts	↓ PDF

Photometric Files

LDT / IES	↓ LDT
-----------	-------

Technical Drawings

2D	↓ ZIP
3D	↓ ZIP
Bim	↓ ZIP



Schematic light drawing

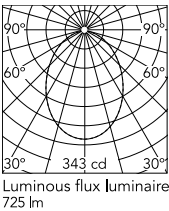

Ecodesign and Energy Labelling

This product contains a light source of energy efficiency class F



Replaceable (LED only)
light source by a
professional

Photometric

Lighting type	Direct
Light distribution	Roto symmetric
CCT (K)	2700
CRI>	90

Electrical

Insulation class	II
Frequency (Hz)	50/60
Main voltage (Vac)	220-240
LED voltage Vf (Vdc)	null
Driver	Integrated
Dimmable	Yes
Dimming type	Mains Cut Dimming
Dimming interface	Remote Dimmable (Dimmer Not Included)
Batteries inside	No

Accessories & Power Supply



OPTIONAL

F0093030

Aim Multiple Canopy



OPTIONAL

RF22227

Aim Dimmer

Spare Parts

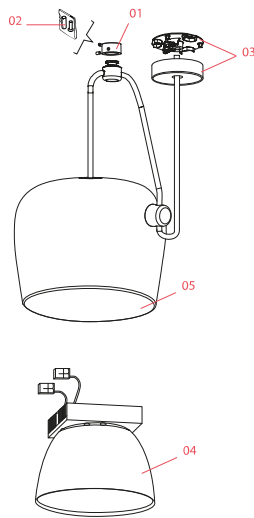

- | | | |
|-----|---|-----------|
| 01. | Black ceiling attachment assembly | RF0090130 |
| 02. | Kit of quantity 3 m4 screws | RF06750 |
| 03. | Ceiling rose assembly | RF1555030 |
| 04. | Aim Small Heatsink, 2700K Led Module & Reflector Assembly | RF0095600 |
| 05. | Aim small opal diffuser | RF0095500 |

DOWNLOAD



RF0090130

Black ceiling attachment assembly



RF06750

Kit of quantity 3 m4 screws



RF1555030

Ceiling rose assembly

FLOS

RF0095600

Aim Small Heatsink, 2700K Led
Module & Reflector Assembly



RF0095500

Aim small opal diffuser

FLOS



F0095039 Ivy Anodized

Aim Small

Designed by Ronan & Erwan Bouroullec, 2014



12W - 725lm - 2700K - CRI> 90

Suspended light fitting. Body in varnished aluminium sheet, shade in photo-etched optical polycarbonate. Internal reflector in photo-etched PC. Directionable body. Powered directly from mains. The LED can be dimmed with a «Triac for Led» dimmer approved by Flos. Flos does not respond in case of wrong electrical connection system installations. The cable has a useful length of 9 metres and thus the lamp can be suspended 3 metres from the ceiling. Multiple rose with capacity to connect up to 5 Aim Small also available.

Are you a professional and your project needs consulting and support?

BOOK AN APPOINTMENT

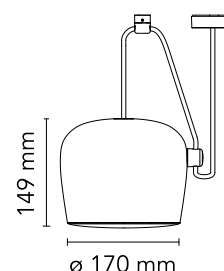

Main specifications

EAN	8059607013533
Mounting	Suspension
Environments	Indoor dry location
Light Source Type	LED
LED type	LED Module
Power (W)	12
System power (W)	12
System flux (lm)	725

Physical

Colour	Ivy Anodized
Length (mm)	170
Cord length (mm)	9000
Net weight (kg)	1.35
Package height (mm)	310
Package width (mm)	300
Package length (mm)	300
Package volume (m3)	0.03
IP internal	20

Download

Mounting instructions	↓ PDF
Compatible dimmers	↓ PDF
Spare Parts	↓ PDF

Photometric Files

LDT / IES	↓ LDT
-----------	-------

Technical Drawings

2D	↓ ZIP
3D	↓ ZIP
Bim	↓ ZIP



Schematic light drawing

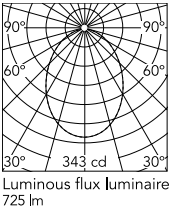

Ecodesign and Energy Labelling

This product contains a light source of energy efficiency class F

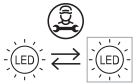

Replaceable (LED only)
light source by a
professional

Photometric

Lighting type	Direct
Light distribution	Roto symmetric
CCT (K)	2700
CRI>	90

Electrical

Insulation class	II
Frequency (Hz)	50/60
Main voltage (Vac)	220-240
LED voltage Vf (Vdc)	null
Driver	Integrated
Dimmable	Yes
Dimming type	Mains Cut Dimming
Dimming interface	Remote Dimmable (Dimmer Not Included)
Batteries inside	No

Accessories & Power Supply



OPTIONAL
F0093030
Aim Multiple Canopy



OPTIONAL
RF22227
Aim Dimmer

Spare Parts

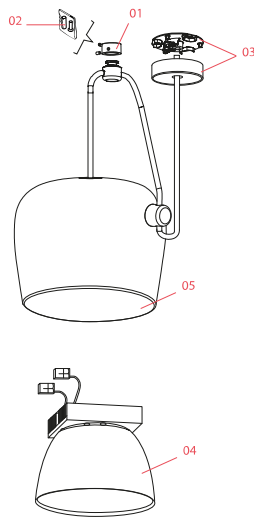

- | | | |
|-----|---|-----------|
| 01. | Ivy green ceiling attachment assembly | RF0090139 |
| 02. | Kit of quantity 3 m4 screws | RF06750 |
| 03. | Ceiling rose assembly | RF1555030 |
| 04. | Aim Small Heatsink, 2700K Led Module & Reflector Assembly | RF0095600 |
| 05. | Aim small opal diffuser | RF0095500 |

DOWNLOAD



RF0090139

Ivy green ceiling attachment assembly



RF06750

Kit of quantity 3 m4 screws



RF1555030

Ceiling rose assembly

FLOS

RF0095600

Aim Small Heatsink, 2700K Led Module & Reflector Assembly



RF0095500

Aim small opal diffuser

FLOS

F0095054 Light Silver Anodized

Aim Small

Designed by Ronan & Erwan Bouroullec, 2014

12W - 725lm - 2700K - CRI> 90

Suspended light fitting. Body in varnished aluminium sheet, shade in photo-etched optical polycarbonate. Internal reflector in photo-etched PC. Directionable body. Powered directly from mains. The LED can be dimmed with a «Triac for Led» dimmer approved by Flos. Flos does not respond in case of wrong electrical connection system installations. The cable has a useful length of 9 metres and thus the lamp can be suspended 3 metres from the ceiling. Multiple rose with capacity to connect up to 5 Aim Small also available.

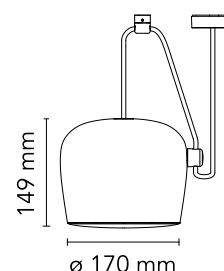

Are you a professional and your project needs consulting and support?

BOOK AN APPOINTMENT

Main specifications

EAN	8059607000113
Mounting	Suspension
Environments	Indoor dry location
Light Source Type	LED
LED type	LED Module
Power (W)	12
System power (W)	12
System flux (lm)	725

Physical

Colour	Light Silver Anodized
Length (mm)	170
Cord length (mm)	9000
Net weight (kg)	1.35
Package height (mm)	310
Package width (mm)	300
Package length (mm)	300
Package volume (m3)	0.03
IP internal	20

Download

Mounting instructions	↓ PDF
Compatible dimmers	↓ PDF
Spare Parts	↓ PDF

Photometric Files

LDT / IES	↓ LDT
-----------	-------

Technical Drawings

2D	↓ ZIP
3D	↓ ZIP
Bim	↓ ZIP



Schematic light drawing

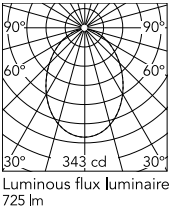

Ecodesign and Energy Labelling

This product contains a light source of energy efficiency class F

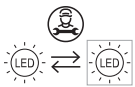

Replaceable (LED only)
light source by a
professional

Photometric

Lighting type	Direct
Light distribution	Roto symmetric
CCT (K)	2700
CRI>	90

Electrical

Insulation class	II
Frequency (Hz)	50/60
Main voltage (Vac)	220-240
LED voltage Vf (Vdc)	null
Driver	Integrated
Dimmable	Yes
Dimming type	Mains Cut Dimming
Dimming interface	Remote Dimmable (Dimmer Not Included)
Batteries inside	No

Accessories & Power Supply



OPTIONAL

F0093030

Aim Multiple Canopy



OPTIONAL

RF22227

Aim Dimmer

Spare Parts

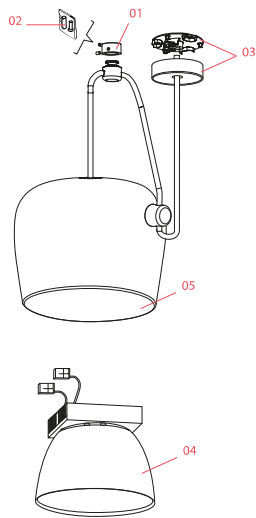

- | | | |
|-----|---|-----------|
| 01. | Natural anodized ceiling attachment assembly | RF0090154 |
| 02. | Kit of quantity 3 m4 screws | RF06750 |
| 03. | Ceiling rose assembly | RF1555030 |
| 04. | Aim Small Heatsink, 2700K Led Module & Reflector Assembly | RF0095600 |
| 05. | Aim small opal diffuser | RF0095500 |

DOWNLOAD



RF0090154
Natural anodized ceiling
attachment assembly



RF06750
Kit of quantity 3 m4 screws



RF1555030
Ceiling rose assembly

FLOS

RF0095600
Aim Small Heatsink, 2700K Led
Module & Reflector Assembly



RF0095500
Aim small opal diffuser

FLOS

F0090009 White

Aim

Designed by Ronan & Erwan Bouroullec, 2013

16W - 895lm - 2700K

Suspended light fitting. Body in varnished aluminium sheet, shade in photo-etched optical polycarbonate. Internal reflector in photo-etched ABS. Orientable body. Powered directly from mains. The LED can be dimmed with a «Triac for Led» dimmer approved by Flos. Flos does not respond in case of wrong electrical connection system installations. The cable has a useful length of 9 meters and thus the lamp can be suspended 3 meters from the ceiling. Multiple rose with capacity to connect up to 5 Aims also available.

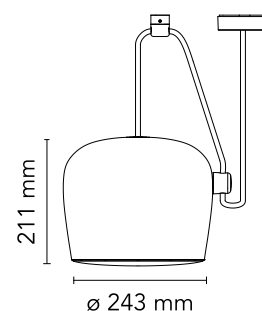

Are you a professional and your project needs consulting and support?

BOOK AN APPOINTMENT

Main specifications

EAN	8059607013267
Mounting	Suspension
Environments	Indoor dry location
Light Source Type	LED
LED type	LED Module
Power (W)	16
System flux (lm)	895

Physical

Colour	White
Length (mm)	243
Cord length (mm)	9000
Net weight (kg)	3.2
Package height (mm)	375
Package width (mm)	300
Package length (mm)	300
Package volume (m3)	0.03
IP internal	20
IP external	20

Download

Mounting instructions	↓ PDF
Compatible dimmers	↓ PDF
Spare Parts	↓ PDF

Photometric Files

LDT / IES	↓ LDT
-----------	-------

Technical Drawings

2D	↓ ZIP
3D	↓ ZIP
Bim	↓ ZIP



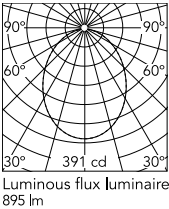

Schematic light drawing



Ecodesign and Energy Labelling

This product contains a light source of energy efficiency class F



Replaceable (LED only)
light source by a
professional

Photometric

Lighting type	Direct
Light distribution	Roto symmetric
CCT (K)	2700

Electrical

Insulation class	II
Frequency (Hz)	50/60
Main voltage (Vac)	220-240
LED voltage Vf (Vdc)	null
Driver	Integrated
Dimmable	Yes
Dimming type	Mains Cut Dimming
Dimming interface	Remote Dimmable (Dimmer Not Included)
Batteries inside	No

Accessories & Power Supply



OPTIONAL

F0093009

Aim Multiple Canopy



OPTIONAL

RF22227

Aim Dimmer

Spare Parts

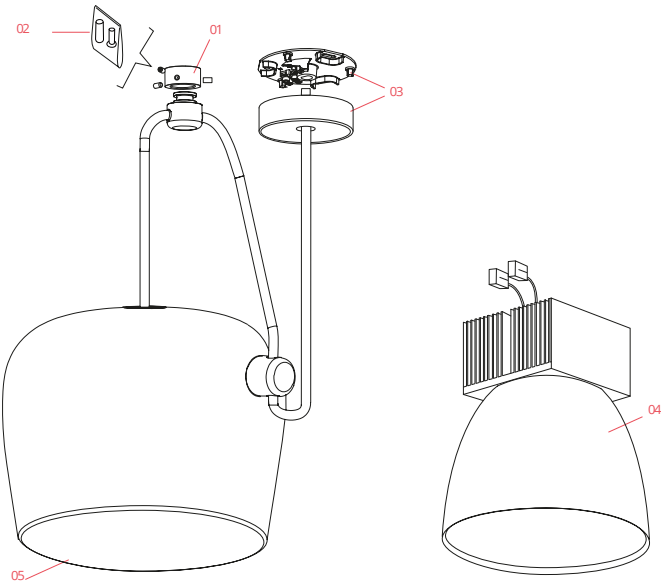

- | | | |
|-----|--|-----------|
| 01. | Ceiling attachment assembly | RF0090109 |
| 02. | Kit of quantity 3 m4 screws | RF06749 |
| 03. | White ceiling rose assembly | RF0090209 |
| 04. | Aim Heatsink, 2700K Led Module
& Reflector Assembly | RF0090700 |
| 05. | Aim opal diffuser | RF0090600 |

DOWNLOAD



RF0090109

Ceiling attachment assembly



RF06749

Kit of quantity 3 m4 screws



RF0090209

White ceiling rose assembly

FLOS

RF0090700

Aim Heatsink, 2700K Led Module
& Reflector Assembly

FLOS

RF0090600

Aim opal diffuser

FLOS

F0090023 Blue Steel Anodized

Aim

Designed by Ronan & Erwan Bouroullec, 2013

16W - 895lm - 2700K - CRI> 90

Suspended light fitting. Body in varnished aluminium sheet, shade in photo-etched optical polycarbonate. Internal reflector in photo-etched ABS. Orientable body. Powered directly from mains. The LED can be dimmed with a «Triac for Led» dimmer approved by Flos. Flos does not respond in case of wrong electrical connection system installations. The cable has a useful length of 9 meters and thus the lamp can be suspended 3 meters from the ceiling. Multiple rose with capacity to connect up to 5 Aims also available.

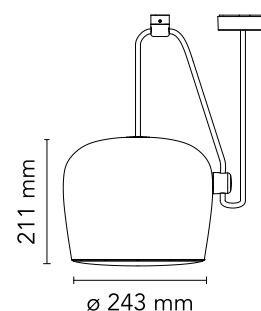

Are you a professional and your project needs consulting and support?

BOOK AN APPOINTMENT

Main specifications

EAN	8059607013274
Mounting	Suspension
Environments	Indoor dry location
Light Source Type	LED
LED type	LED Module
Power (W)	16
System power (W)	16
System flux (lm)	895

Physical

Colour	Blue Steel Anodized
Length (mm)	243
Net weight (kg)	3.2
Package height (mm)	375
Package width (mm)	300
Package length (mm)	300
Package volume (m3)	0.03
IP internal	20

Download

Mounting instructions	↓ PDF
Compatible dimmers	↓ PDF
Spare Parts	↓ PDF

Photometric Files

LDT / IES	↓ LDT
-----------	-------

Technical Drawings

2D	↓ ZIP
3D	↓ ZIP
Bim	↓ ZIP



Schematic light drawing

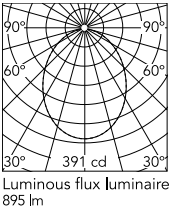

Ecodesign and Energy Labelling

This product contains a light source of energy efficiency class F

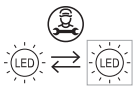

Replaceable (LED only) light source by a professional

Photometric

Lighting type	Direct
Light distribution	Roto symmetric
CCT (K)	2700
CRI>	90

Electrical

Insulation class	II
Frequency (Hz)	50/60
Main voltage (Vac)	220-240
LED voltage Vf (Vdc)	null
Driver	Integrated
Dimmable	Yes
Dimming type	Mains Cut Dimming
Dimming interface	Remote Dimmable (Dimmer Not Included)
Batteries inside	No

Accessories & Power Supply



OPTIONAL
F0093030
Aim Multiple Canopy



OPTIONAL
RF22227
Aim Dimmer

Spare Parts

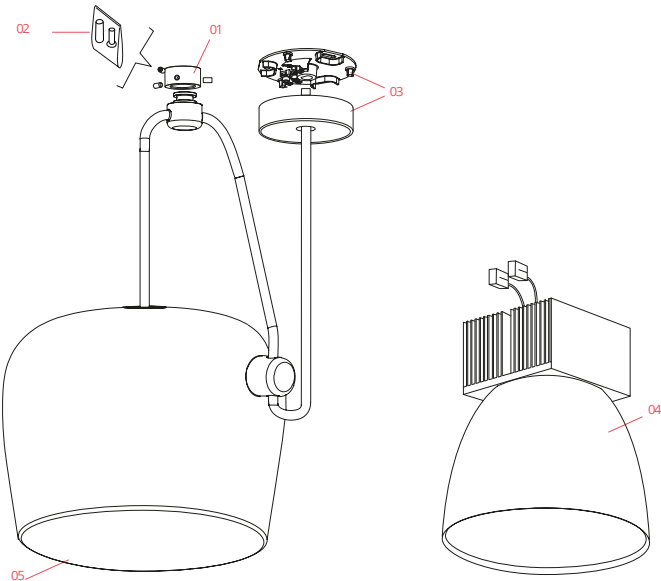

- | | | |
|-----|---|-----------|
| 01. | Dark grey/steel blue ceiling attachment assembly | RF0090123 |
| 02. | Kit of quantity 3 m4 screws | RF06750 |
| 03. | Black ceiling rose assembly | RF0090230 |
| 04. | Aim Heatsink, 2700K Led Module & Reflector Assembly | RF0090700 |
| 05. | Aim opal diffuser | RF0090600 |

DOWNLOAD



RF0090123

Dark grey/steel blue ceiling
attachment assembly



RF06750

Kit of quantity 3 m4 screws



RF0090230

Black ceiling rose assembly

FLOS

RF0090700

Aim Heatsink, 2700K Led Module
& Reflector Assembly

FLOS

RF0090600

Aim opal diffuser

FLOS

F0090054 Light Silver Anodized

Aim

Designed by Ronan & Erwan Bouroullec, 2013

16W - 895lm - 2700K - CRI> 90

Suspended light fitting. Body in varnished aluminium sheet, shade in photo-etched optical polycarbonate. Internal reflector in photo-etched ABS. Orientable body. Powered directly from mains. The LED can be dimmed with a «Triac for Led» dimmer approved by Flos. Flos does not respond in case of wrong electrical connection system installations. The cable has a useful length of 9 meters and thus the lamp can be suspended 3 meters from the ceiling. Multiple rose with capacity to connect up to 5 Aims also available.

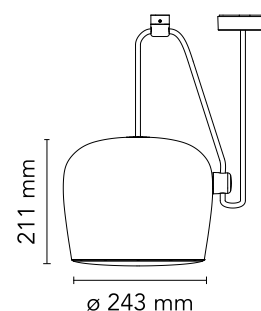

Are you a professional and your project needs consulting and support?

BOOK AN APPOINTMENT

Main specifications

EAN	8059607000076
Mounting	Suspension
Environments	Indoor dry location
Light Source Type	LED
LED type	LED Module
Power (W)	16
System power (W)	16
System flux (lm)	895

Physical

Colour	Light Silver Anodized
Length (mm)	243
Cord length (mm)	9000
Net weight (kg)	3.2
Package height (mm)	375
Package width (mm)	300
Package length (mm)	300
Package volume (m3)	0.03
IP internal	20

Download

Mounting instructions	↓ PDF
Compatible dimmers	↓ PDF
Spare Parts	↓ PDF

Photometric Files

LDT / IES	↓ LDT
-----------	-------

Technical Drawings

2D	↓ ZIP
3D	↓ ZIP
Bim	↓ ZIP



Schematic light drawing

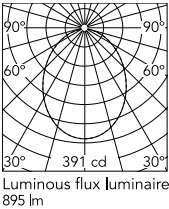

Ecodesign and Energy Labelling

This product contains a light source of energy efficiency class F

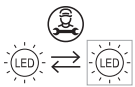

Replaceable (LED only)
light source by a
professional

Photometric

Lighting type	Direct
Light distribution	Roto symmetric
CCT (K)	2700
CRI>	90

Electrical

Insulation class	II
Frequency (Hz)	50/60
Main voltage (Vac)	220-240
LED voltage Vf (Vdc)	null
Driver	Integrated
Dimmable	Yes
Dimming type	Mains Cut Dimming
Dimming interface	Remote Dimmable (Dimmer Not Included)
Batteries inside	No

Accessories & Power Supply



OPTIONAL

F0093030

Aim Multiple Canopy



OPTIONAL

RF22227

Aim Dimmer

Spare Parts

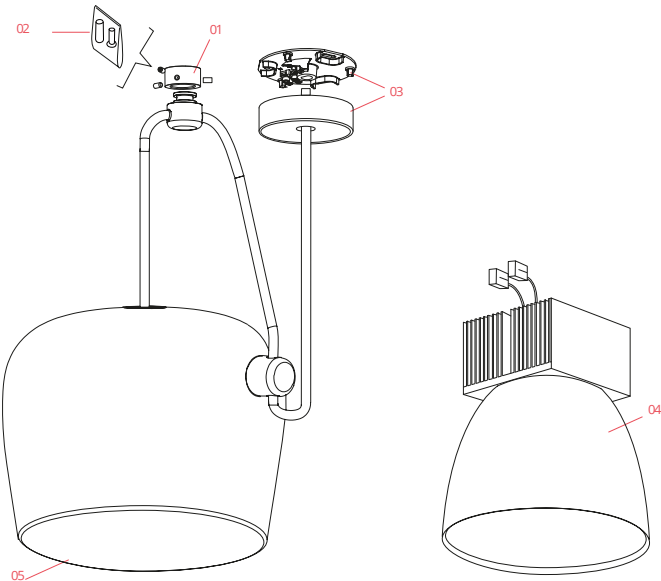

- | | | |
|-----|---|-----------|
| 01. | Natural anodized ceiling attachment assembly | RF0090154 |
| 02. | Kit of quantity 3 m4 screws | RF06750 |
| 03. | Black ceiling rose assembly | RF0090230 |
| 04. | Aim Heatsink, 2700K Led Module & Reflector Assembly | RF0090700 |
| 05. | Aim opal diffuser | RF0090600 |

DOWNLOAD



RF0090154

Natural anodized ceiling
attachment assembly



RF06750

Kit of quantity 3 m4 screws



RF0090230

Black ceiling rose assembly

FLOS

RF0090700

Aim Heatsink, 2700K Led Module
& Reflector Assembly

FLOS

RF0090600

Aim opal diffuser