

## GLISS-UP — PATRICIA URQUIOLA 2014

1—  
10



Gliss-Up is the first entirely suspended bedroom system. In her approach to wardrobes Patricia Urquiola overturns the traditional concept which simply stands units on the floor; here they are instead suspended to the wall. The space below is now freed up for use in other ways: for instance, with large shelves, these too suspended, to provide a space for drawer units, baskets and original design accessories. custom designed in the traditional finishes of the Gliss series and in the new cedar finish studied ad hoc for Gliss-Up interiors.

**DATASHEET**

REGISTERED  
DESIGN

VII.2016

**molteni.it**

Dimensions in millimeters and inches. The right to discontinue and make changes is reserved. This information is based on the latest product information available at the time of printing.

## FINISHES

### Finishes

cedar	matt lacquer colours	eucalyptus	glossy lacquer colours	titanium	satined aluminium	saffiano grey
-------	----------------------------	------------	------------------------------	----------	----------------------	------------------

### wardrobe components

structure with back						
wood hinged door						
external side panel						
internal shelves						
clothes rails						
<b>support shelf</b>						
<b>drawer units</b>						
storage unit structure						
front						
drawer interior						

### colours

#### Matt lacquer

BC chalk white  
AV ivory  
PE pearl  
DN dune  
PL platinum  
PB lead  
NE black  
AT anthracite  
SE mustard  
SI silica  
DO dolomite grey  
AL clay  
MK moka  
CM caramel  
CZ light blue grey  
SA sand  
RU ruby  
CI cadmium  
VB baltic green

#### Glossy lacquer

BC chalk white  
PE pearl  
DN dune  
PL platinum  
PB lead  
NE black  
AT anthracite  
SE mustard  
SI silica  
DO dolomite grey  
AL clay  
MK moka  
CM caramel  
CZ light blue grey  
SA sand  
RU ruby  
CI cadmium  
VB baltic green

## TECHNICAL INFORMATION

### WARDROBE FRAME, SHELF

Chipboard panel covered in Cedar wood (Cedrus) veneer.

### SIDE PANEL (WOOD INTERIOR, MATT LACQUERED EXTERIOR)

Chipboard panel covered in Cedar wood (Cedrus) veneer on the interior and melamine facing on the exterior, painted in Molteni range colours.

### HINGED DOORS

Chipboard panel covered in Eucalyptus wood veneer or melamine facing, painted in Molteni range colours.

### TRIM

Extruded aluminium covered with Cedar veneer.

### SIDE PANEL EXTENSION PROFILE

Extruded aluminium covered in Eucalyptus wood veneer or painted in Molteni range colours.

### CLOTHES RODS

Rod in chromed steel. Rod support bracket in chromed plastic.

### SUPPORT SHELF

Honeycomb panel, covered in Eucalyptus wood veneer or melamine facing, painted in Molteni range colours. Metal brackets for mounting on the wall.

### DRAWER UNIT FRAME

Chipboard panel covered with melamine facing, painted in Molteni range colours.

### DRAWER FRONT

Composite panel of MDF and sheet aluminium (1 mm thick), painted in Molteni range colours.

### SIDES AND BOTTOM - DRAWER INTERIOR

Chipboard panel covered with melamine facing.

## TECHNICAL INFORMATION

Molteni & C

4—  
10

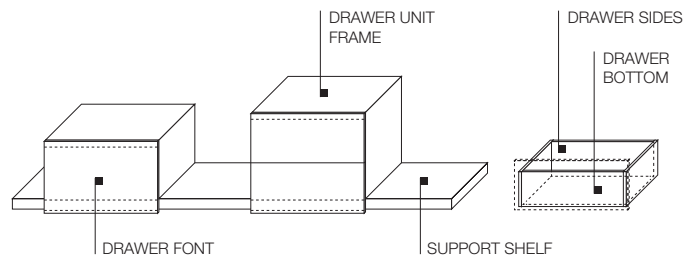
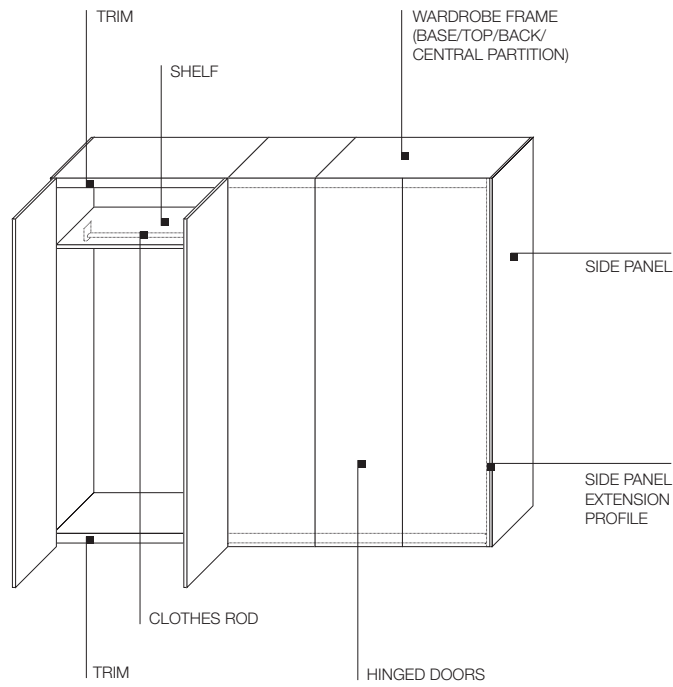

### DATASHEET

REGISTERED  
DESIGN

VII.2016

TYPES / DIMENSIONS

Molteni & C

5—  
10

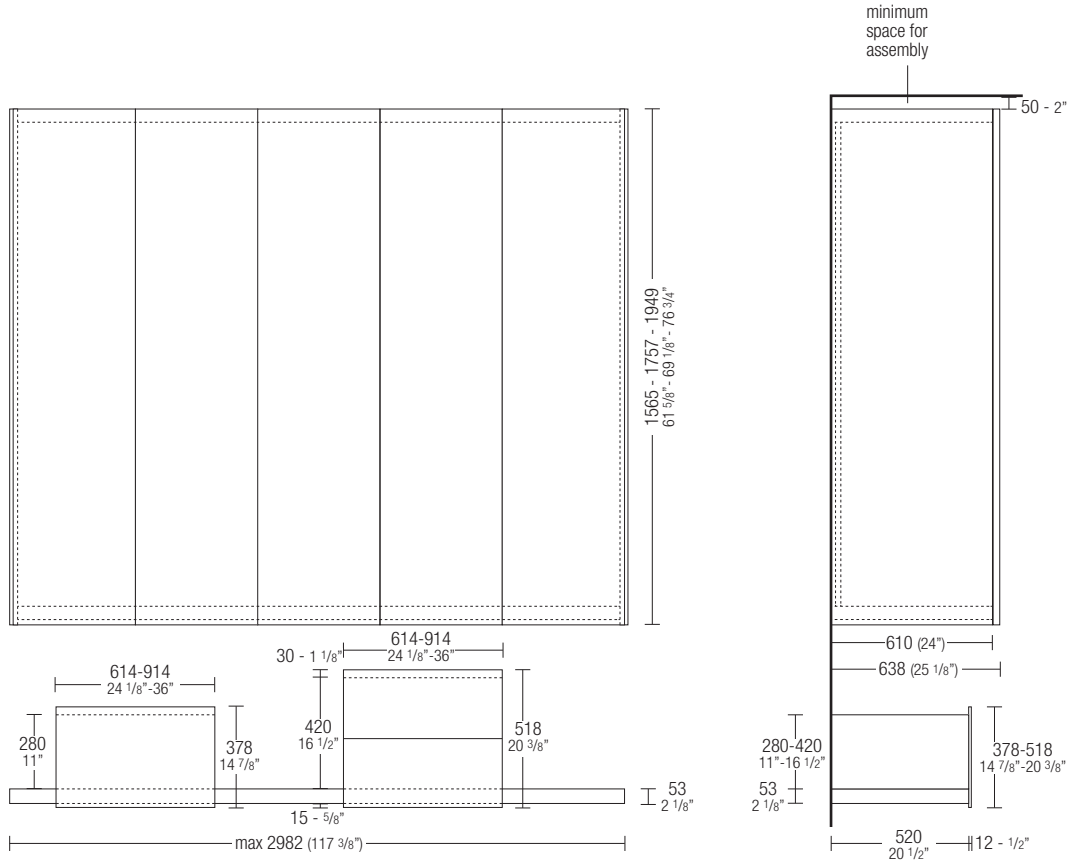

DATASHEET

REGISTERED  
DESIGN

VII.2016

**TYPES / DIMENSIONS**

**Module H 1565 (61 5/8")**

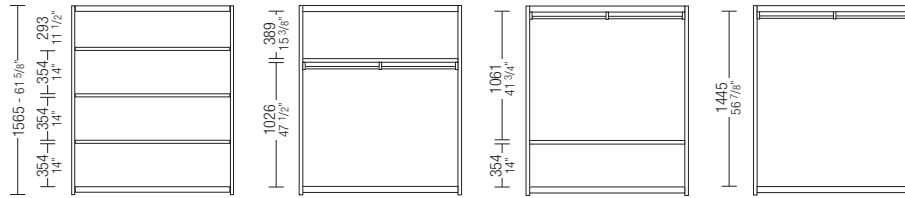

**Module H 1757 (69 1/8")**

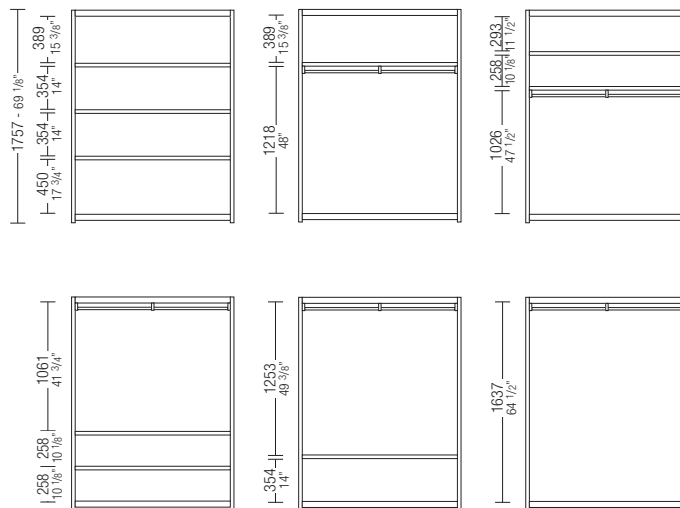

**Module H 1949 (76 3/4")**

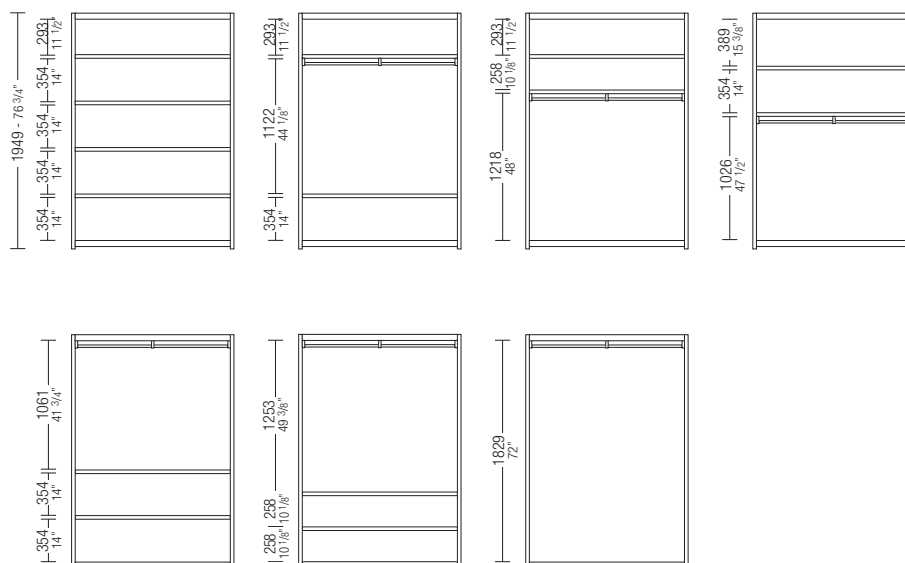

**Molteni & C**

## TYPES / DIMENSIONS

### Support shelf and drawer units

The standard model support shelf comes in three different sizes: mm 2982 (117 3/8"), 2654 (101 1/2") and 1998 (78 5/8").

These sizes can be cut to measure to the centimetre. The minimum measurement possible is mm 1342 (52 7/8").

Drawer units are fixed elements which cannot be modified, and are made to always be positioned on the support shelf.

Drawers always have totally extractable runners and the interior is always made in saffiano grey.

# Molteni & C

7—  
10

### Drawer units H 280 (11")

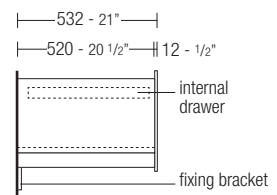
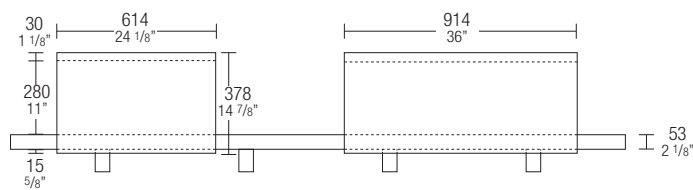

open

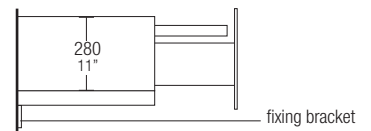

Drawer units H 280 (11") are always made with an internal drawer.

### Drawer units H 420 (16 1/2")

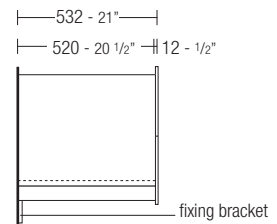
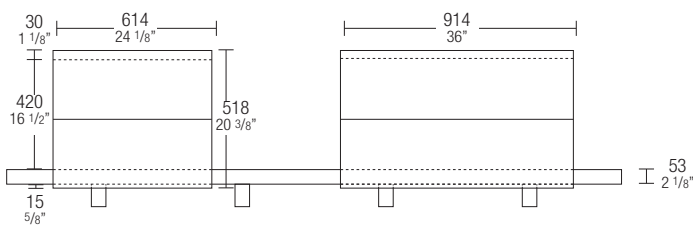

open

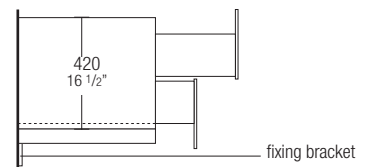

### DATASHEET

REGISTERED  
DESIGN

VII.2016

**molteni.it**

Dimensions in millimeters and inches. The right to discontinue and make changes is reserved. This information is based on the latest product information available at the time of printing.

**MODULARITY**

**Molteni & C**

8—  
10

1670 78 5/8"			
820 32 1/4"	820 32 1/4"		
984 38 3/4"	656 25 7/8"		
1834 72 1/4"			
984 38 3/4"	820 32 1/4"		
1312 51 5/8"	492 19 3/8"		
1998 78 5/8"			
984 38 3/4"	984 38 3/4"		
1312 51 5/8"	656 25 7/8"		
2162 85 1/8"			
984 38 3/4"	656 25 7/8"	492 19 3/8"	
820 32 1/4"	820 32 1/4"	492 19 3/8"	
2326 91 5/8"			
1312 51 5/8"	984 38 3/4"		
820 32 1/4"	820 32 1/4"	656 25 7/8"	
2490 98"			
984 38 3/4"	984 38 3/4"	492 19 3/8"	
1312 51 5/8"	656 25 7/8"	492 19 3/8"	
820 32 1/4"	820 32 1/4"	820 32 1/4"	
2654 104 1/2"			
1312 51 5/8"	1312 51 5/8"		
984 38 3/4"	984 38 3/4"	656 25 7/8"	
492 19 3/8"	820 32 1/4"	820 32 1/4"	492 19 3/8"
2818 111"			
656 25 7/8"	984 38 3/4"	492 19 3/8"	656 25 7/8"
984 38 3/4"	820 32 1/4"	984 38 3/4"	
2982 117 3/8"			
984 38 3/4"	984 38 3/4"	984 38 3/4"	
3146 123 7/8"			
1312 51 5/8"	1312 51 5/8"	492 19 3/8"	
820 32 1/4"	820 32 1/4"	820 32 1/4"	656 25 7/8"
3310 130 3/8"			
820 32 1/4"	820 32 1/4"	820 32 1/4"	820 32 1/4"
656 25 7/8"	1312 51 5/8"	1312 51 5/8"	
3474 136 3/4"			
984 38 3/4"	492 19 3/8"	984 38 3/4"	984 38 3/4"
1312 51 5/8"	820 32 1/4"	1312 51 5/8"	
3638 143 1/4"			
984 38 3/4"	984 38 3/4"	984 38 3/4"	656 25 7/8"
984 38 3/4"	820 32 1/4"	820 32 1/4"	984 38 3/4"
1312 51 5/8"	1312 51 5/8"	984 38 3/4"	
3802 149 3/4"			
1312 51 5/8"	984 38 3/4"	984 38 3/4"	492 19 3/8"
656 25 7/8"	1312 51 5/8"	1312 51 5/8"	492 19 3/8"
3966 156 1/8"			
1312 51 5/8"	1312 51 5/8"	1312 51 5/8"	1312 51 5/8"
984 38 3/4"	984 38 3/4"	984 38 3/4"	984 38 3/4"

**DATASHEET**

REGISTERED  
DESIGN

VII.2016



## WEIGHT LIMITS

### Instructions for mounting the wardrobe on the wall

Gliss-Up was tested in compliance with the UNI EN 14749 standard: “Domestic and kitchen storage units and worktops - Safety requirements and test methods.”

Each module can hold a maximum total weight of Kg. 120, and each single element has a weight limit (listed below) which must not be exceeded.

Specific brackets are provided to mount the wardrobe on the wall, but a kit of wall anchors is not provided because the appropriate fasteners must be defined by the dealer for each installation on the basis of the type of material used to make the wall and the structure of the wall. This guarantees safety and that wardrobe capacity is compliant with the weight limits listed herein.

We recommend a very scrupulous evaluation of the structural conditions of the wall prior to ordering and mounting the product.

Plates and bars provided are made to measure depending on the dimensions of the wall mounted wardrobe and the position of the partitions. These parts cannot be modified afterwards.

Mounting procedures must be carried out in an excellent manner and after viewing the specific “Mounting instructions”. Stability and capacity of the wardrobe are guaranteed only by correct mounting and by following the manufacturer’s instructions.

---

### Weight limits

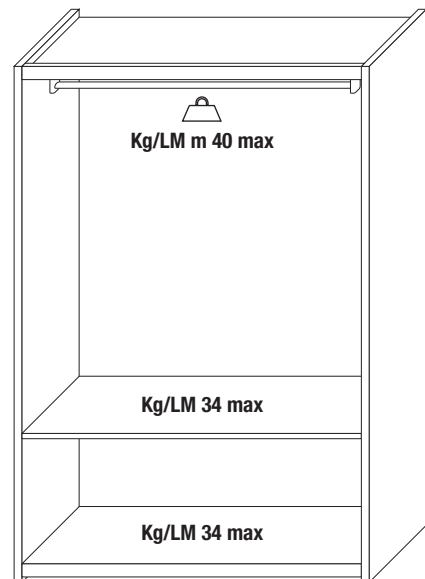
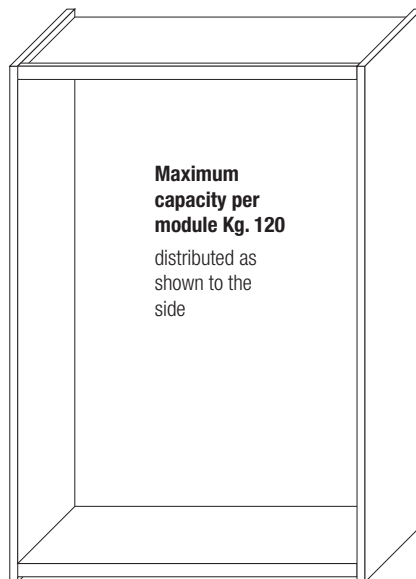

### Max. capacity per single element

with these capacities, shelf deflection will be in conformity with standard UNI EN 16121 - UNI EN 16122

## LED LIGHTING

Internal compartments of Gliss-Up wardrobes can be equipped with LED lighting. The lighting bar can be mounted on the top pieces or the shelves. In this case, shelves will have to be permanently mounted in their positions. For each shelf measure, we have made specific lighting bars with wiring compliant with European safety standards. Lighting bars can be reduced with a surcharge for the shelf cutting.

### Warning

When placing the order, the customer must indicate on the drawing where he would like the lighting bar to be placed and the position (height) inside the compartment.

# Molteni & C

10—  
10

### lighting bars 3000 K

W 462  
6 watt

W 626  
8 watt

W 790  
10 watt

W 954  
12 watt

W 1282  
16 watt

EBI4C

EBI6C

EBI8C

EBI9C

EBI13C

### components per system

(see the diagram for  
component use and to  
calculate system cost)

### power supply unit 100W

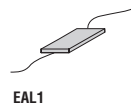

### sensor

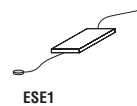

### connector

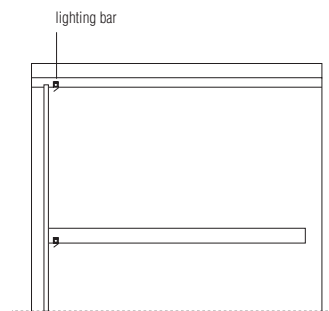

### System construction diagram

A composition (wardrobe) can be equipped with more than one system and more than one power supply unit.

### system with sensor for each compartment

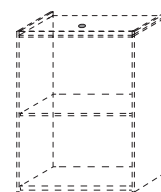

\* each power supply unit can power a max. of 100W or:  
max 6 sensors  
max 6 LED lights

sensor (1 per compartments)	●
power supply unit (per composition *)	●
connector (for compositions of 4 power supply units max.)	●

### DATASHEET

REGISTERED  
DESIGN

VII.2016

molteni.it

Dimensions in millimeters and inches. The right to discontinue and make changes is reserved. This information is based on the latest product information available at the time of printing.

# Molteni & C

## FINISHES MOLTENI&C RANGE

IX.2016

	MATT LACQUER OPEN GRAIN LACQUER	GLOSSY LACQUER	COLOURED GLASS	ETCHED COLOURED GLASS	PLASTER LACQUERED CARTAPAGLIA LACQUERED <i>only Gliss Master</i>	STOPSOL
CHALK WHITE	•	•	•	•	•	
IVORY	•				•	
PEARL	•	•	•	•	•	
SILICA	•	•	•	•	•	
SAND	•	•	•	•	•	
PLATINUM	•	•	•	•	•	
DUNE	•	•	•	•	•	
CLAY	•	•	•	•	•	
DOLOMITE GREY	•	•	•	•	•	
RUBY	•	•	•	•	•	
CARAMEL	•	•	•	•	•	
MOKA	•	•	•	•	•	
MUSTARD	•	•	•	•	•	
CADMIUM	•	•	•	•	•	
LIGHT BLUE GREY	•	•	•	•	•	
BALTIC GREEN	•	•	•	•	•	
LEAD	•	•	•	•	•	
ANTHRACITE	•	•	•	•	•	
BLACK	•	•	•	•	•	
BRONZE				•		
GREY						•
LESSLESS RED <i>only matt lacquer</i>	•					

# Molteni & C

## FINISHES MOLTENI&C RANGE

IX.2016

### WOODS

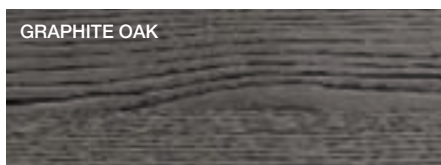
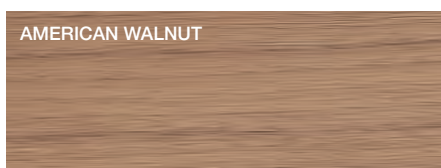
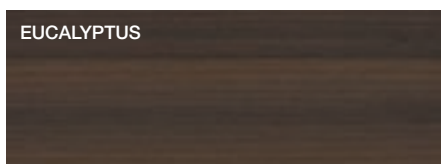

### MARBLES

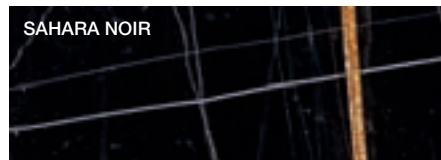
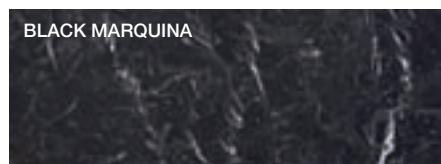
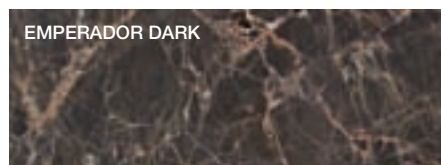
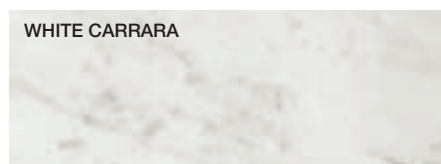

### GRES

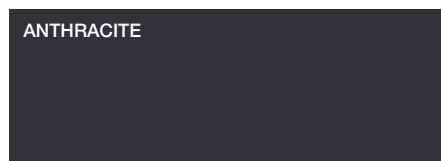
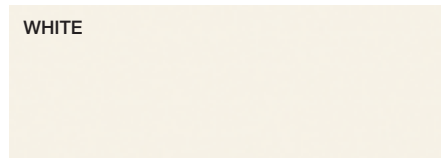

### METAL PARTS

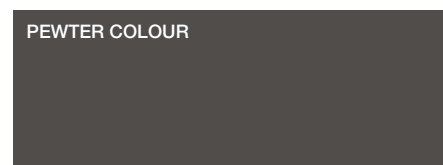
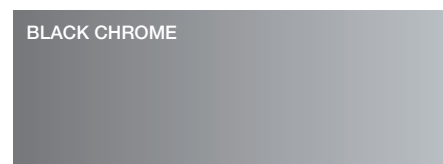

DWELL  
DOOR FRAME, TRACK COVERING PROFILES

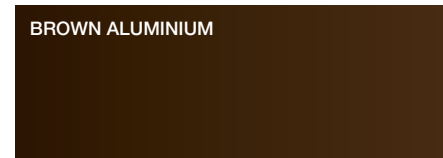

The finishes shown are indicative and refer to the entire production range. We recommend that you consult the "Colour Range" samples which shown the complete range of finishes, including those not shown here. Molteni&C reserves the right to modify the range without warning.