

Molteni & C

GLISS WALK-IN— MDT 2013

1—
12



Gliss Walk-In is a system of walk-in closets allowing to design made to measure compositions, with both linear and corner solutions. Compositions can be wall-mounted with or without back panels (cartapaglia white and anthracite melamine, larix dark, lacquered, glass or mirror finish). The equipment can be freely positioned in height, thanks to a system of concealed, self-locking brackets. A simple design and the wide customisation of the equipment allow solutions for any need.

DATASHEET

REGISTERED
DESIGN

IX.2015

molteni.it

Dimensions in millimeters and inches. The right to discontinue and make changes is reserved. This information is based on the latest product information available at the time of printing.

FINISHES

finishes	natural anodised	black anodised	cartapaglia melamine colours	larix dark	matt lacquer colours	woods	coloured glass/ etched coloured glass	mirror/ Kyoto glass	shiny chrome
components									
wall profile									
lateral finishing profile									
back panels									
base									
plinth on base									
shelves									
clothes rails									
structure of trays/drawer units									
fronts of wood drawer units									
drawer units finishing tops									

colours

**Matt
lacquer**

BC chalk white
AV ivory
PE pearl
DN dune
PL platinum
PB lead
NE black
BO bordeaux
AT anthracite
SE mustard
SI silica
DO dolomite grey
AL clay
MK moka
CM caramel
CZ light blue grey
SA sand
RU ruby
CI cadmium

Woods

EU eucalyptus
RG grey oak
RN black oak
OC light elm
OS dark elm

**Coloured
glass**

BC chalk white
PE pearl
DN dune
PL platinum
PB lead
NE black
BO bordeaux
AT anthracite
SE mustard
SI silica
DO dolomite grey
AL clay
MK moka
CM caramel
CZ light blue grey
SA sand
RU ruby
CI cadmium

**Etched coloured
glass**

BC chalk white
PE pearl
DN dune
PL platinum
PB lead
NE black
BO bordeaux
AT anthracite
SE mustard
SI silica
DO dolomite grey
AL clay
MK moka
CM caramel
CZ light blue grey
SA sand
RU ruby
CI cadmium

**Cartapaglia
melamine**

KB white
KA anthracite

DATASHEET

REGISTERED
DESIGN

IX.2015

TECHNICAL INFORMATION

WALL PROFILE

Extruded anodised aluminium.

MELAMINE FACED SHELF/BASE

Wooden particleboard panel faced with melamine. Metal brackets to fasten the shelf to the wall profile. Adjustable feet for the base.

LACQUERED SHELF/BASE

Wooden particleboard panel faced with melamine, painted in the colours of the “Molteni Range”. Metal brackets to fasten the shelf to the wall profile. Adjustable feet for the base.

WOOD SHELF/BASE

Wooden particleboard panel faced with wood veneer in Oak (Quercus), Elm (Ulmus rubra) or Eucalyptus (Eucalyptus globulus). Metal brackets to fasten the shelf to the wall profile. Adjustable feet for the base.

BACK PANEL, DRAWER UNIT STRUCTURE, DRAWER AND TRAY FRONTS, DRAWER SIDES AND BOTTOM (MELAMINE FACED)

Wooden particleboard panel faced with melamine.

BACK PANEL, DRAWER UNIT STRUCTURE, DRAWER AND TRAY FRONTS (LACQUER)

Wooden particleboard panel faced with melamine, painted in the colours of the “Molteni Range”.

BACK PANEL (GLASS VERSIONS)

Wooden particleboard panel faced with melamine, with applied mirror or tempered glass (th. 5 mm), transparent or etched, painted in the colours of the “Molteni Range”.

GLASS DRAWER FRONT

Wooden particleboard panel faced with melamine or painted in the colours of the “Molteni Range”. Tempered glass th. 4 mm.

CLOTHES RAILS

Tube in chrome plated steel. Tube support in chromed plastic.

LATERAL FINISHING PROFILE

Medium density fibre panels faced with melamine paper, painted in the colours of the “Molteni Range”.

SHOE RACK ROD OR TROUSER ROD

In anodised extruded aluminium with plastic insert.

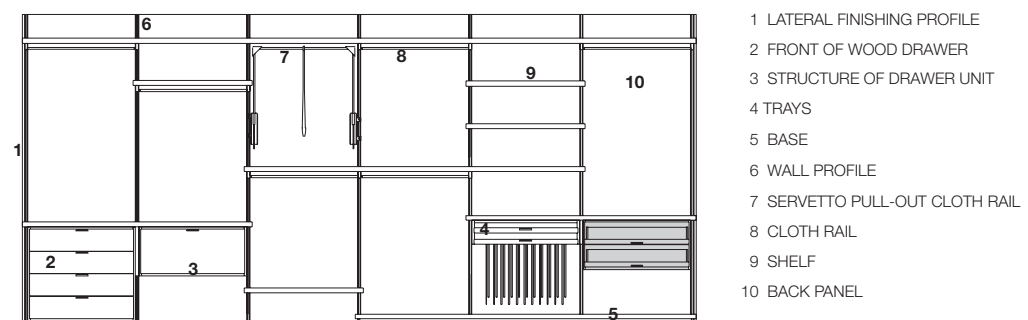

DRAWER INTERIOR

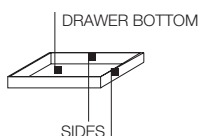

MODULARITY

Methods of executing custom cuttings

In height:

- all vertical profiles (wall-mounted, spacers, finishing profiles) can be reduced to the desired size
- the height of the back panels is custom cut

In width:

- custom reduction up to -614 mm (24 1/8") is available **only on 1 module**
- the minimum possible width for a module is 328 mm
- **the size of trays and modular drawer units cannot be reduced**
- hanging structures can be fastened only to standard compartments with W 942 (37 1/8")

- if a wider shelf is placed on top of any drawer unit (either freestanding, suspended or resting on the base), the drawer unit must be of standard width 942 (37 1/8").
- two drawer units are available for compartments cut to measure (suspended, standing on base or floor standing).

Molteni & C

4—
12

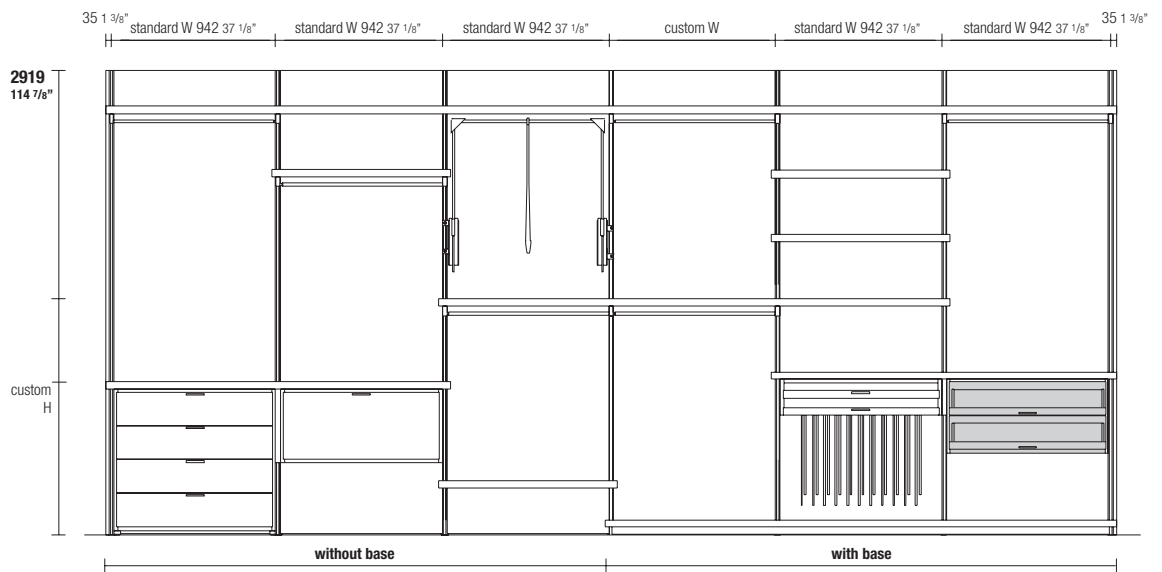

module with or without back panel

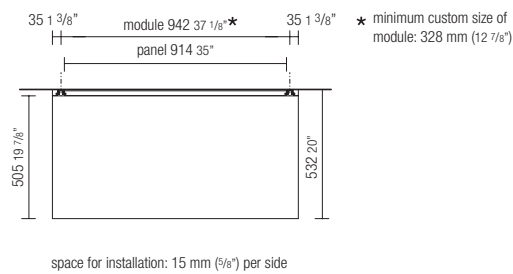

corner element with or without back panel

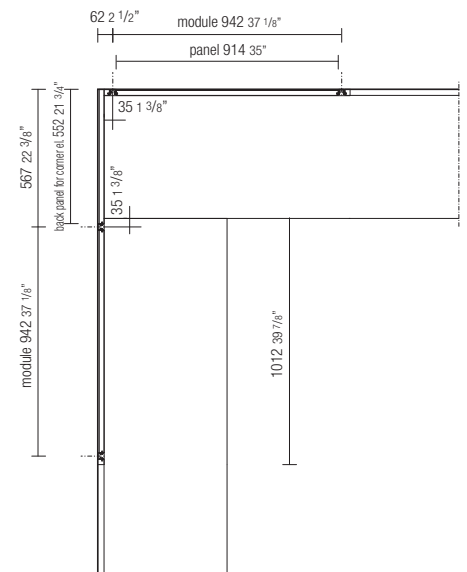

DATASHEET

REGISTERED
DESIGN

IX.2015

molteni.it

Dimensions in millimeters and inches. The right to discontinue and make changes is reserved. This information is based on the latest product information available at the time of printing.

MODULARITY

Linear composition with or without back panels

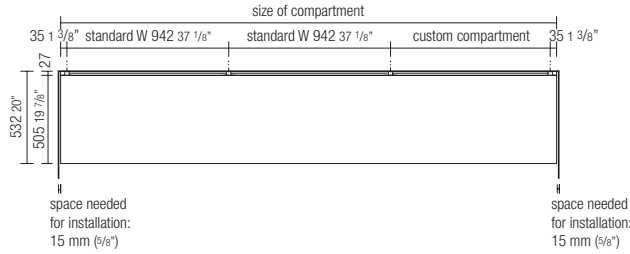

Molteni & C

5—
12

Corner composition with or without back panels

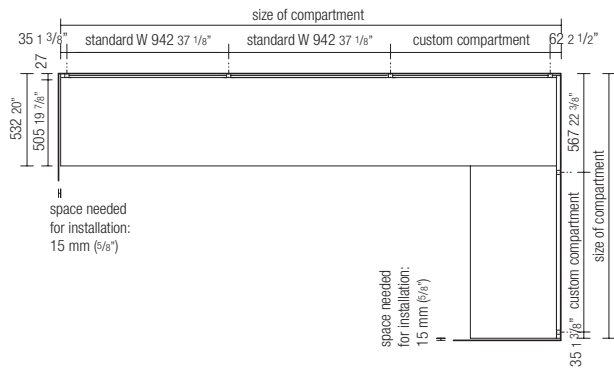

C-shaped corner composition with or without back panels

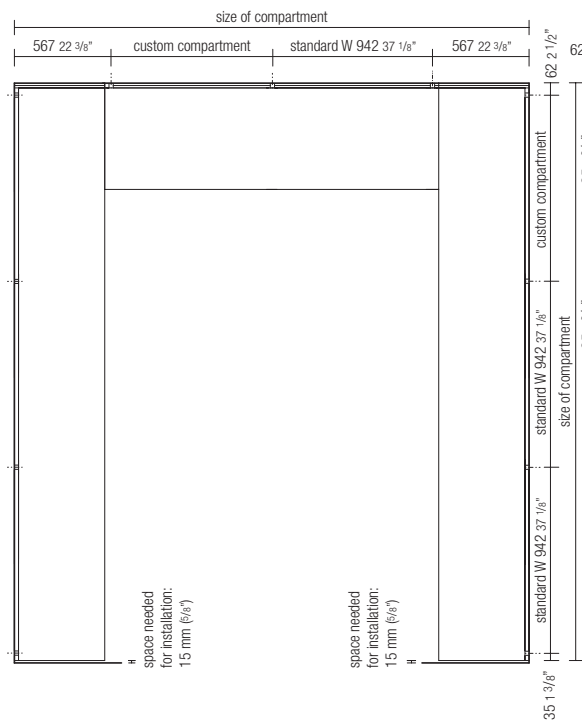

C-shaped corner composition without back panels on corners

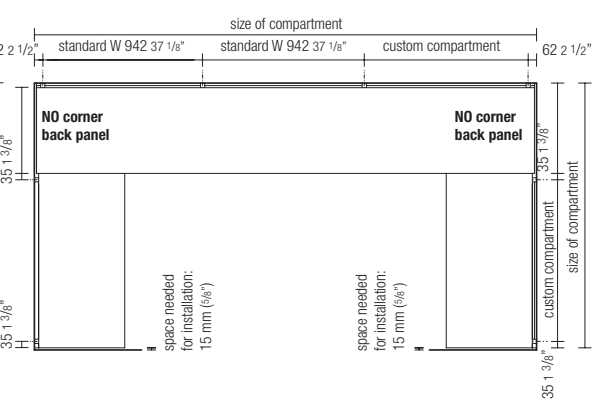

DATASHEET

REGISTERED
DESIGN

IX.2015

molteni.it

Dimensions in millimeters and inches. The right to discontinue and make changes is reserved. This information is based on the latest product information available at the time of printing.

NOTES

- hanging structures with H 110 can contain any tray
- hanging structures with H 206 can contain trays and also a pull-out tray or a H 190 drawer
- drawers, pull-out trays and trinket trays can be freely installed on all other structures, according to the height of the module
- the interiors of the drawers have always a grey saffiano melamine finish
- in case there is no shelf placed over the drawer unit, a 10 mm thick finishing top is always needed
- no shelves can be positioned in the modules adjacent to a drawer unit.

Molteni & C

6—
12

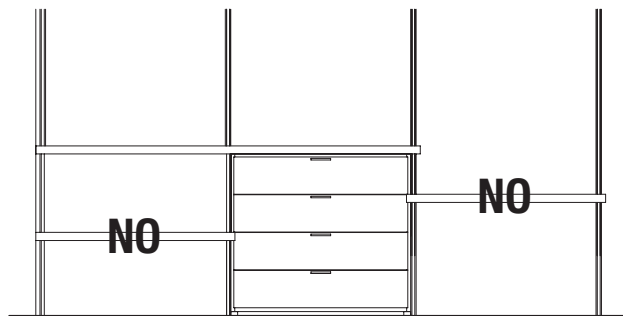

Handle in pewter colour finish

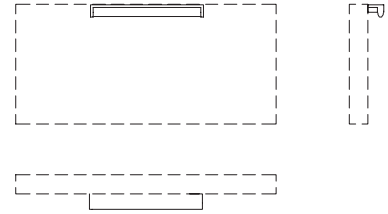

Notes

Prices of drawers, trays and pull-out trays include the cost of the pewter colour finish handle. For the handle covered in Eco Skin, add a supplementary charge.

Reductions

- **the size of trays and drawer units cannot be reduced**
- hanging structures can be fastened only to standard compartments with W 942
- if a shelf is placed on top of a drawer unit (either free-standing or resting on the base) the drawer unit must occupy a standard W 942 module.

Drawer units for width custom compartments

To enhance the functional features and adaptability of Gliss Walk-In to all situations, two drawer units H 417/439 with reduced width are available (W 614 for modules cut to measure up to W 642, and W 450 for modules cut to measure up to W 478). These drawer units can be used suspended above the shelf, either supported by the base or floor standing.

Notes

- Besides the instructions concerning the drawer units 942 W, we add following:
- Drawer units always have two wooden drawers H 190
 - The suspended drawer unit can be positioned either on the left or right part of the reduced module.

example of drawer unit suspended on the left

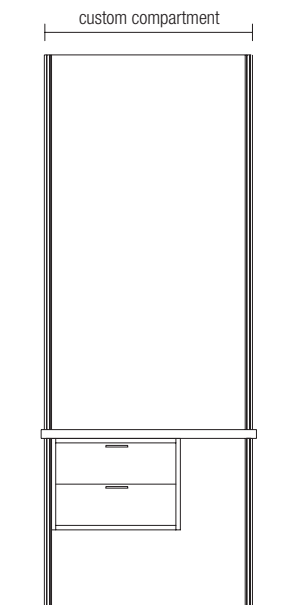

DATASHEET

REGISTERED
DESIGN

IX.2015

molteni.it

Dimensions in millimeters and inches. The right to discontinue and make changes is reserved. This information is based on the latest product information available at the time of printing.

FITTINGS

Base
D 505 th 83 3 1/4"
with adjustable feet

W 1012 39 7/8"
(1 module)

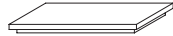

BA5/10

W 1954 76 7/8"
(2 modules)

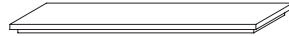

BA5/20

W 2896 114"
(3 modules)



BA5/29

Shelf
D 505 th 40 1 5/8"
with mounting brackets

W 1012 39 7/8"
(1 module)
2 brackets

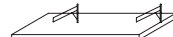

RI5/10

W 1954 76 7/8"
(2 modules)
3 brackets

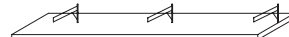

RI5/20

W 2896 114"
(3 modules)
4 brackets

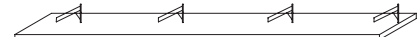

RI5/29

Jointed shelf
D 505 th 40 1 5/8"
with mounting brackets

W from 2897 to 3838
W from 114" to 151 1/8"
(4 modules)
5 brackets



RG5/38

W from 3839 to 4780
W from 151 1/8" to 188 1/4"
(5 modules)
6 brackets

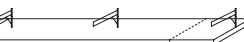

RG5/48

W from 4781 to 5722
W from 188 1/4" to 225 1/4"
(6 modules)
7 brackets



RG5/57

cloth rails
module W 942 37 1/8"



P094

servetto pull-out cloth rail
can be used on W 942 (37 1/8") to
W 670 mm (26 3/8") modules

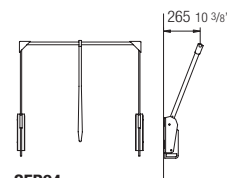

SER94

pull-out coat hanger



AGR1

FITTINGS

pull-out tray
W 884 D 468
W 34 3/4" D 18 3/8"
H 57 2 1/4" (front)

trays
W 884 D 468
W 34 3/4" D 18 3/8"

trouser holder tray
H 57 2 1/4"
n. 11 bars max

**trinket tray
(ties and belts)**
H 57 2 1/4"

**additional trouser
holder bar**
(grey saffiano
embossed finish)

Molteni & C

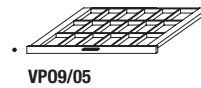
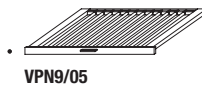
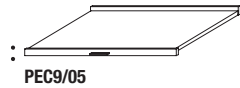

drawers
W 884 D 468 H 190
W 34 3/4" D 18 3/8" H 7 1/2"
usable spaces
W 834 D 435 H 106

wooden drawer

open drawer

glass drawer
in transparent glass serigraphed in
Molteni colour range or in the colour
of the cartapaglia melamine finish

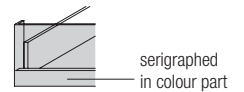
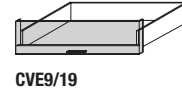
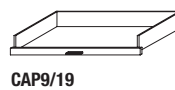
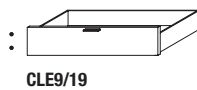

drawers
W 884 D 468 H 382
W 34 3/4" D 18 3/8" H 15"
usable spaces
W 834 D 435 H 298

wooden drawer

open drawer

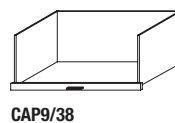
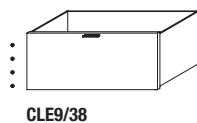

shoe racks
W 884 D 468 H 382
W 34 3/4" D 18 3/8" H 15"
n. 3 shoe racks

**shoe rack with
wooden front panel**

open shoe rack

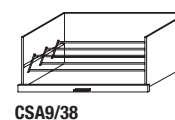
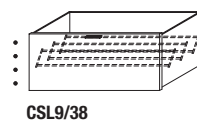

Internal fittings - drawer accessories

Drawer interiors can be equipped with bottoms and trays in grey Eco Skin. Trays are inserted inside drawers following the modularity shown in the diagram.

Eco Skin trays

W 150 D 432 H 50 (A)

tray



A10

tray with
dividers



A11

tray with
dividers

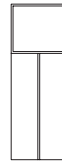

A12

tray with
jewellery holder

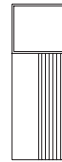

A13

Eco Skin trays

W 365 D 432 H 50 (B)

tray

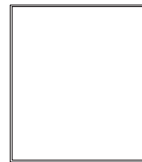

B10

tray with
dividers

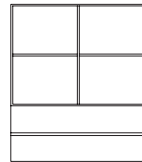

B11

tray with
jewellery holder

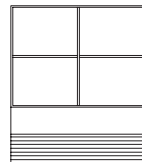

B12

tray with
watch holder

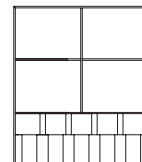

B13

**Modularity drawings
for inserting trays into
drawers**

drawer W 420

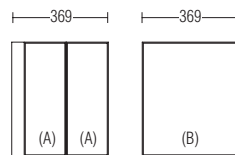

drawer W 584

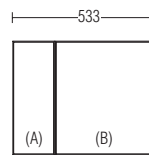

drawer W 884

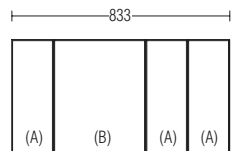

**Eco Skin bottoms
for drawers**
D 432

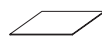

W 366
CEQ/F4

W 530
CEQ/F6

W 830
CEQ/F9

DATASHEET

REGISTERED
DESIGN

IX.2015

FITTINGS

Recessed LED spotlight for shelves

Features

The spotlight is powered by No. 3 AA batteries (inclusive) and does not need a connection to the electrical system. Lighting is automatic thanks to a volumetric sensor-controlled system. The spotlight has an ON/OFF switch allowing to turn it off when not in use for long periods.

Notes

Tests performed with high quality, non-rechargeable batteries (as the ones supplied with) report a duration of about 1 year when the spotlight is operated for 30 seconds 4 times a day. The use of rechargeable batteries reduces the light intensity of the spotlight.

recessed LED spotlight (batteries included)

W 184 D 40
W 7 1/4" D 1 5/8"

centrally positioned in the module, even in small module, up to 328 mm

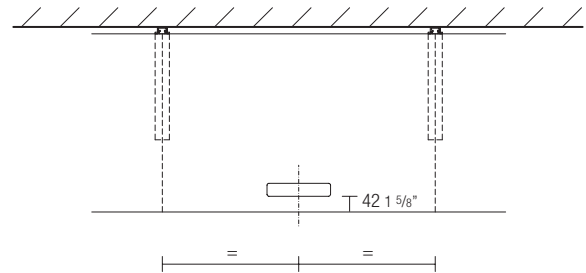

HF1

Led lighting

Shelves can be accessorised with LED lighting. Lighting systems are conformant with European safety standards.

Notes

At the moment of the order, the customer must always indicate on the drawing the shelf or the shelves where the lighting bars should be installed. The bars will always follow the width of the shelf. If the shelf is jointed, two bars will be made, one for each part of the shelf.

lighting bars for shelves

consider two singles bars for jointed shelves

for shelves up to W 1012 - 39 7/8"



watt 12
EBI10

for shelves up to W 1954 - 76 7/8"



watt 22
EBI20

for shelves up to W 2896 - 114"



watt 33
EBI29

each power supply kit can turn on max 6 bars that do not go over 100 W.

If this wattage is surpassed, two or more kits must be purchased.

power supply kit for system turned on through remote control

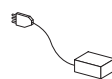

EBKT

SAMPLE COMPOSITIONS

composition 1

backs: cartapaglia melamine/larix dark
shelves: cartapaglia melamine/larix dark
fittings: cartapaglia melamine/larix dark

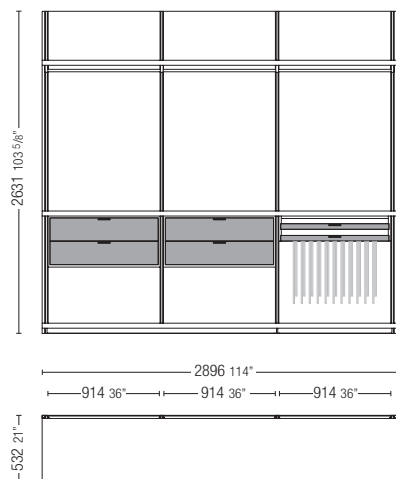

GCC01

composition 2

backs: cartapaglia melamine/larix dark
shelves: cartapaglia melamine/larix dark
fittings: cartapaglia melamine/larix dark

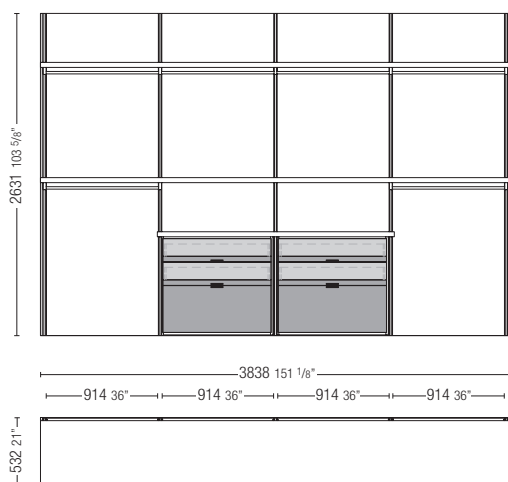

GCC02

DATASHEET

REGISTERED
DESIGN

IX.2015

SAMPLE COMPOSITIONS

composition 3

backs: cartapaglia melamine/larix dark
shelves: cartapaglia melamine/larix dark
fittings: cartapaglia melamine/larix dark

Molteni & C

12—
12

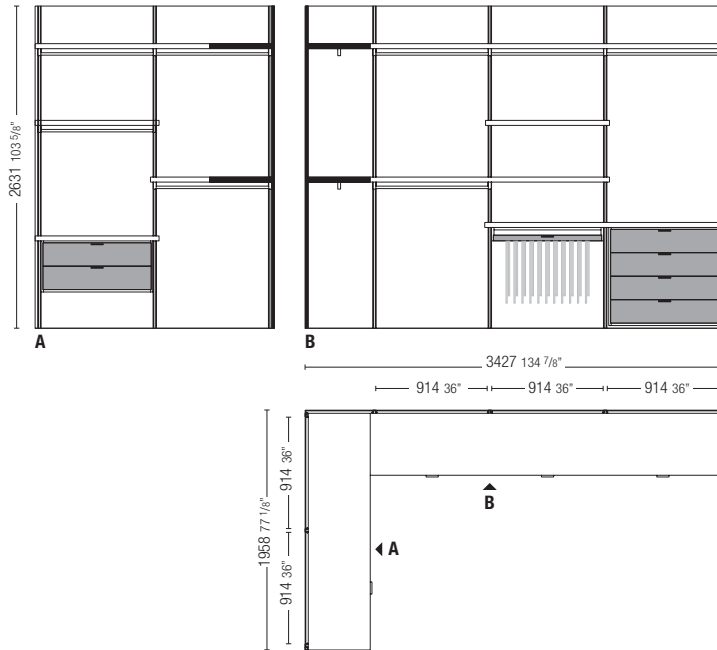

GCC03

composition 4

backs: cartapaglia melamine/larix dark
shelves: cartapaglia melamine/larix dark
fittings: cartapaglia melamine/larix dark

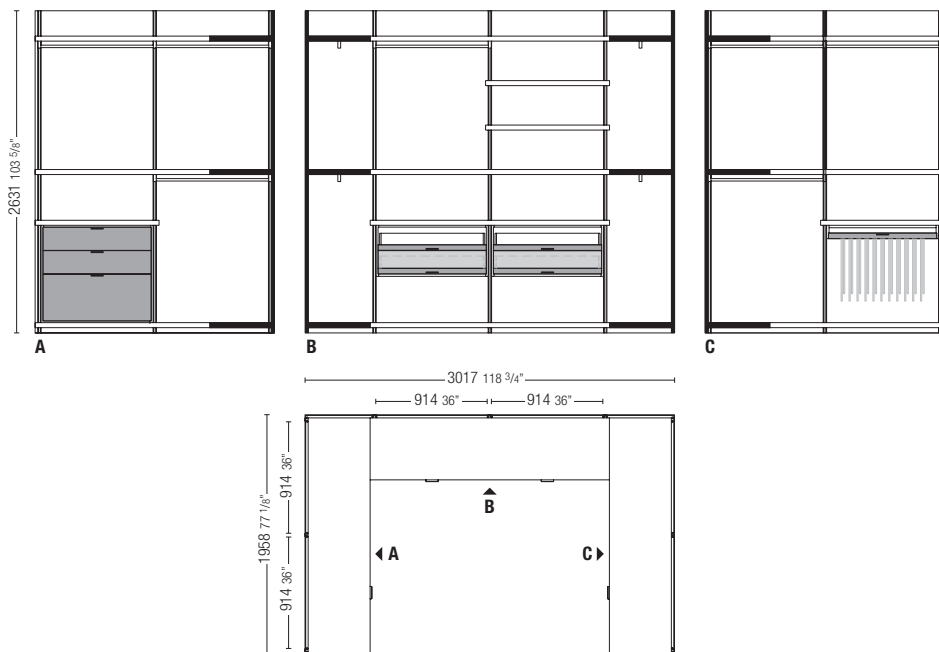

GCC04

DATASHEET

REGISTERED
DESIGN

IX.2015

molteni.it

Dimensions in millimeters and inches. The right to discontinue and make changes is reserved. This information is based on the latest product information available at the time of printing.

FINISHES MOLteni&C RANGE

IX.2015

	MATT LACQUER OPEN GRAIN LACQUER	GLOSSY LACQUER	COLOURED GLASS	ETCHED COLOURED GLASS	PLASTER LACQUERED CARTAPAGLIA LACQUERED <i>only Gliss Master</i>
CHALK WHITE	•	•	•	•	•
IVORY	•				•
PEARL	•	•	•	•	•
SILICA	•	•	•	•	•
SAND	•	•	•	•	•
PLATINUM	•	•	•	•	•
DUNE	•	•	•	•	•
CLAY	•	•	•	•	•
DOLOMITE GREY	•	•	•	•	•
BORDEAUX	•	•	•	•	•
RUBY	•	•	•	•	•
CARAMEL	•	•	•	•	•
MOKA	•	•	•	•	•
MUSTARD	•	•	•	•	•
CADMIUM	•	•	•	•	•
LIGHT BLUE GREY	•	•	•	•	•
LEAD	•	•	•	•	•
ANTHRACITE	•	•	•	•	•
BLACK	•	•	•	•	•
LESSLESS RED	•				
<i>only matt lacquer</i>					

Molteni & C

FINISHES MOLTENI&C RANGE

IX.2015

WOODS

EUCALYPTUS

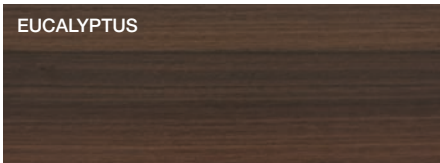

AMERICAN WALNUT



GREY OAK



BLACK OAK

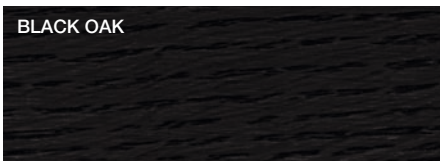

DARK ELM



LIGHT ELM



CEDAR



MARBLES

WHITE CARRARA

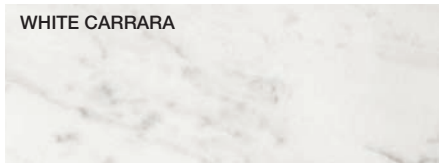

RED LAGUNA



EMPERADOR DARK

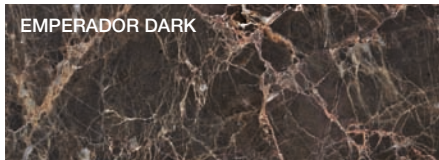

BLACK MARQUINA

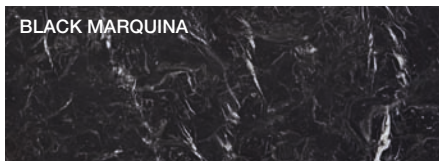

GRES

WHITE

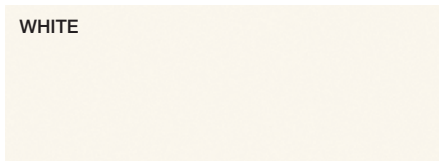

ANTHRACITE



METAL PARTS

BLACK CHROME

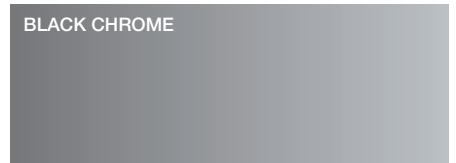

SHINY ALUMINIUM

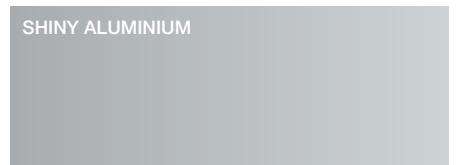

PEWTER COLOUR

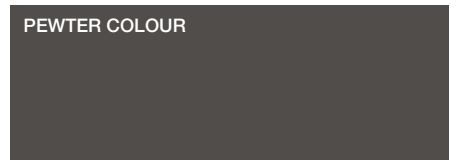

DWELL
DOOR FRAME, TRACK COVERING PROFILES

ANODISED ALUMINIUM



BROWN ALUMINIUM

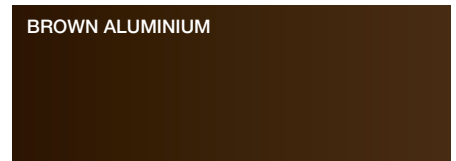

The finishes shown are indicative and refer to the entire production range. We recommend that you consult the "Colour Range" samples which shown the complete range of finishes, including those not shown here. Molteni&C reserves the right to modify the range without warning.

Molteni & C

FINISHES MOLTENI&C RANGE

IX.2015

MILLERIGHE
GLISS QUICK FRONT

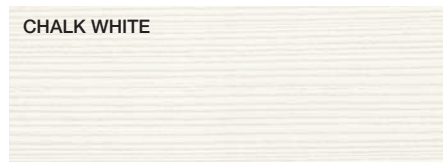

CARTAPAGLIA
GLISS MASTER FRONT
GLISS QUICK, GLISS WALK-IN FRONT

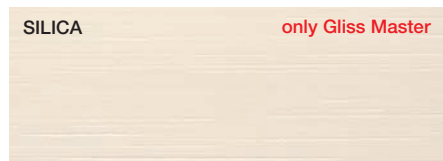
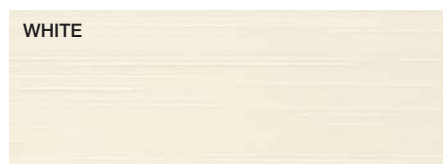

MILLERIGHE
GLISS QUICK, GLISS-UP STRUCTURE

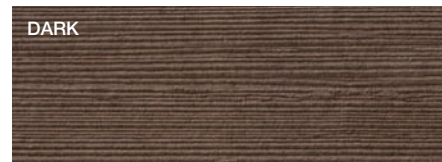
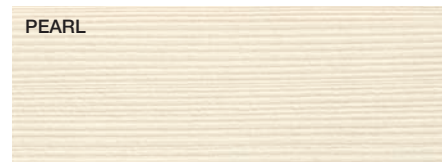

ECO SKIN **only Gliss Master**

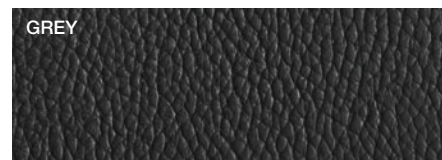
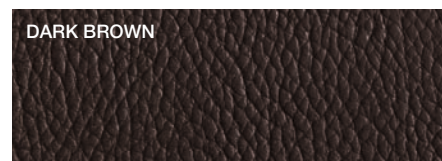
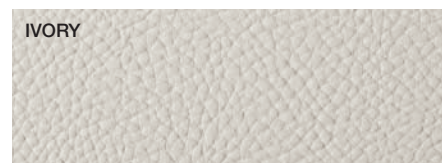

PLASTER **only Gliss Master**

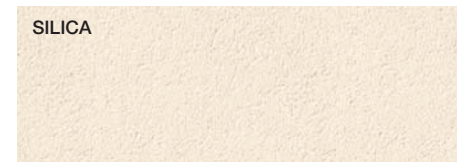

MELAMINE STRUCTURE **only Gliss Master**

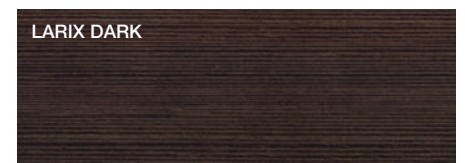
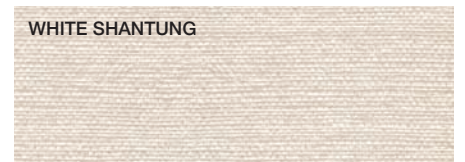

Larix dark finish available also for Gliss Walk-In where specifically indicated in the pricelist