

FLOS

F9560009 White

Wan Suspension

Designed by Johanna Grawunder, 2006



Halogen - 40W

Suspension lamp providing direct lighting. Aluminum body, available in shiny white, shiny black and shiny green finishes. Low glare shield. Provided by two different ring due to fix the safety tempered glass, in black and green.

Are you a professional and your project needs consulting and support?

[BOOK AN APPOINTMENT](#)

Main specifications

Mounting	Suspension
Environments	Indoor dry location
Light Source Type	Bulb
Lamp category	Halogen
Lamp holders	G9
Iicos	HSG
Number of heads	1
Power (W)	40

Physical

Colour	White
Length (mm)	115
Cord length (mm)	2800
Net weight (kg)	0.85
Package height (mm)	175
Package width (mm)	220
Package length (mm)	190
Package volume (m3)	0.01
IP internal	20

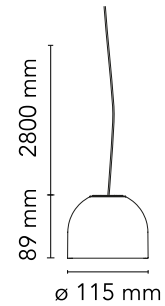

Download

[Mounting instructions](#) PDF

[Spare Parts](#) PDF

Photometric Files

[LDT / IES](#) LDT

Technical Drawings

[2D](#) ZIP

[3D](#) ZIP

[Bim](#) ZIP



Schematic light drawing

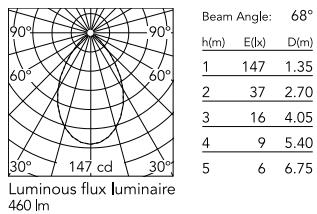

Photometric

Lighting type	Direct
Light distribution	Symmetric

Electrical

Insulation class	II
Frequency (Hz)	50/60
Main voltage (Vac)	220-250
LED voltage Vf (Vdc)	null
Dimmable	Yes
Dimming interface	Remote Dimmable (Dimmer Not Included)
Batteries inside	No

Bulbs



NOT INCLUDED

RF18863

Halogen Lamp G9 33W 2700K

HALOPIN Dimmable

Spare Parts

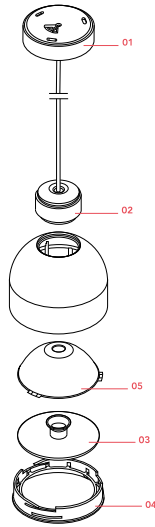

- | | | |
|-----|---|-----------|
| 01. | Black rose assembly | RF9560130 |
| 02. | G9 lamp holder with inner ring
and 2,5mt of electrical cable | RF9560200 |
| 03. | Wan glass assembly | RF9550200 |
| 04. | External ring | RF14546 |
| 04. | External ring | RF13990 |
| 05. | Reflector / ring assembly | RF9550130 |
| 05. | Assembly External Ring for Wan | RF9550139 |

DOWNLOAD



RF9560130
Black rose assembly



RF9560200
G9 lamp holder with inner ring
and 2,5mt of electrical cable



RF9550200
Wan glass assembly



RF14546
External ring



RF13990
External ring



RF9550130
Reflector / ring assembly



RF9550139
Assembly External Ring for Wan

FLOS

■ F9550030 Black

Wan Ceiling/Wall

Designed by Johanna Grawunder, 2005



Halogen - 40W

Wall or ceiling fixture providing direct lighting. Aluminum body, available in shiny white, shiny black and shiny green finishes. Low glare shield. Provided by two different ring due to block the safety tempered glass, in black and green.

Are you a professional and your project needs consulting and support?

[BOOK AN APPOINTMENT](#)

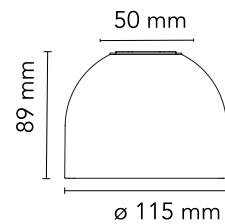

Main specifications

Mounting	Ceiling and wall surface
Environments	Indoor dry location
Light Source Type	Bulb
Lamp category	Halogen
Lamp holders	G9
Ilcos	HSG
Number of heads	1
Power (W)	40

Physical

Colour	Black
Length (mm)	115
Net weight (kg)	0.62
Package height (mm)	175
Package width (mm)	220
Package length (mm)	190
Package volume (m3)	0.01
IP internal	40

Download

[Mounting instructions](#)  PDF

[Spare Parts](#)  PDF

Photometric Files

[LDT / IES](#)  LDT

Technical Drawings

[2D](#)  ZIP

[3D](#)  ZIP



Schematic light drawing

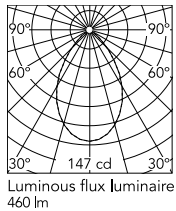

Photometric

Lighting type	Direct
Light distribution	Symmetric

Electrical

Insulation class	II
Frequency (Hz)	50/60
Main voltage (Vac)	220-250
LED voltage Vf (Vdc)	null
Dimmable	Yes
Dimming interface	Remote Dimmable (Dimmer Not Included)
Batteries inside	No

Bulbs

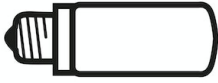

NOT INCLUDED

RF18863

Halogen Lamp G9 33W 2700K

HALOPIN Dimmable

Spare Parts

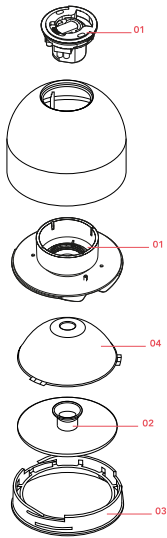

- | | | |
|-----|--|-----------|
| 01. | New type attachment assembly with g9 lamp holder and safety ring | RF9550300 |
| 02. | Wan glass assembly | RF9550200 |
| 03. | External ring | RF13990 |
| 03. | External ring | RF14546 |
| 04. | Reflector / ring assembly | RF9550130 |
| 04. | Assembly External Ring for Wan | RF9550139 |

DOWNLOAD



RF9550300
New type attachment assembly
with g9 lamp holder and safety
ring



RF9550200
Wan glass assembly



RF13990
External ring



RF14546
External ring



RF9550130
Reflector / ring assembly



RF9550139
Assembly External Ring for Wan